



ONE BOARD. NINE SOLUTIONS.

The Complete Stanzani Pulling System



4-10 TON PULLING COVERAGE • FORGED HIGH-GRADE STEEL • INTERCHANGEABLE HARDENED TEETH

Complete Pulling System Includes:

All clamps shown mount to the included wall board with dedicated hooks. Mounting hardware not included.

Autoblock Magnum [Art. 134]

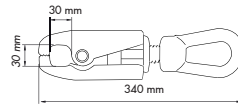

- 10-ton
- Interchangeable Jaws
- 5 Kg | 11 lbs

Applications: Heavy structural pulls, frame rail correction, and high-force pulls on reinforced structural components.



Autoblock Clamp 59mm [Art. 128]

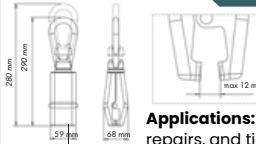

- 6-ton
- Interchangeable Jaws
- 3.5 Kg | 7.72 lbs

Applications: Pinch weld pulls, rocker panel repairs, and tight-access structural pulling points.



Skuba Clamp [Art. 121]

- 6-ton
- Interchangeable Jaws
- 3.2 Kg | 7 lbs

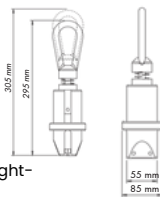

Applications: Pinch weld pulls, rocker panel repairs, and tight-access structural pulling points.



Right Angle Pull Clamp [Art. 133]

- 10-ton
- Interchangeable Jaws
- 3.7 Kg | 8.2 lbs

Applications: Perpendicular pulls on frame rails, pillars, and structural members where pulling direction must change.

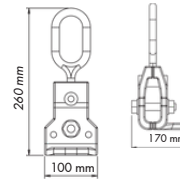

Shark Clamp [Art. 120]

- 6-ton
- Interchangeable Jaws
- 3 Kg | 6.61 lbs

Applications: Raised panel edges, protruding flanges, and areas where traditional clamps cannot seat flat.

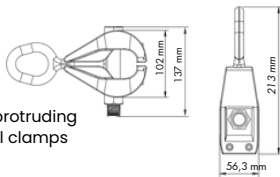

Universal Pull Clamp [Art. 131]

- 10-ton
- Interchangeable Jaws
- 3.3 Kg | 7.3 lbs

Applications: General body pulling, structural straightening, and everyday collision repair pulls.

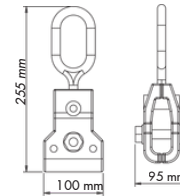

Swivel Pull Clamp [Art. 135]

- 5-ton
- Interchangeable Jaws
- 3.8 Kg | 8.4 lbs

Applications: Multi-directional pulls on quarter panels, rocker panels, and areas requiring angle adjustments.

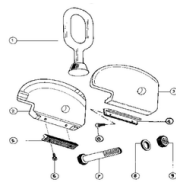

Pull Plier [Art. 144]

- 4-ton
- Interchangeable Jaws
- 3.2 Kg | 7 lbs

Applications: Small panel pulls, sheet metal corrections, and tight-space repairs where larger clamps cannot fit.

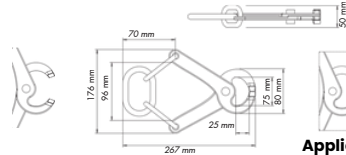

Rapidhook [Art. 136]

- 7-ton
- Interchangeable Jaws
- 2.1 Kg | 4.6 lbs

Applications: Fast chain attachment points, quick setup for pulling operations, and connecting chains.

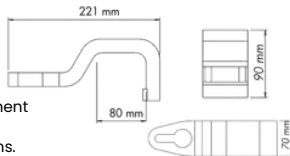

INQUIRE IN BOOTH FOR EXCLUSIVE SHOW PRICING

Speak with a CRTE Sales Rep to review special packages & limited-time offers
Valid April 22- May 15, 2026



Show Special Valid Through May 15, 2026

ONE BOARD. NINE SOLUTIONS.
The Complete Stanzani Pulling System

Professional collision repair requires more than one clamp. **It requires a complete pulling system engineered for every type of structural repair.**

The Stanzani 9-Piece Clamp Board brings together nine specialized pulling tools into one organized workstation. From tight-access structural pulls to heavy-duty frame corrections, each clamp is engineered to deliver **controlled pulling force with maximum grip on modern vehicle structures.**

Manufactured in Italy from high-grade steel, Stanzani clamps are designed to remain in service for years. Replaceable hardened teeth, serviceable components, and precision machining ensure that technicians can maintain peak performance without resorting to improvised hardware or generic replacements.

Instead of piecing together mismatched tools, technicians get a complete pulling solution mounted and ready for use.

Promotion valid from April 22, 2026 through May 15, 2026.

Offer valid only in the continental United States and exclusively through Innovative CRTE.

Shipping, taxes, and installation are not included. Images are for illustrative purposes only.

BUILT FOR MODERN COLLISION REPAIR

- 100% Made in Italy
- High-grade hardened steel construction
- Interchangeable Teeth
- System pull range from **4-ton to 10-ton**
- Engineered for modern vehicle materials including HSS
- Precision-machined jaw geometry **prevents clamp slippage** during high-force pulls

BUILT FOR SAFETY & SERVICEABILITY

- Replaceable hardened teeth maintain proper grip geometry
 - Fully serviceable components extend tool life
 - Factory replacement consumables always available
 - Eliminates unsafe improvised repairs using generic hardware
- Stanzani clamps are engineered to be maintained — not improvised.**

View the full Stanzani clamp lineup and build your complete pulling system.

